

## Photo

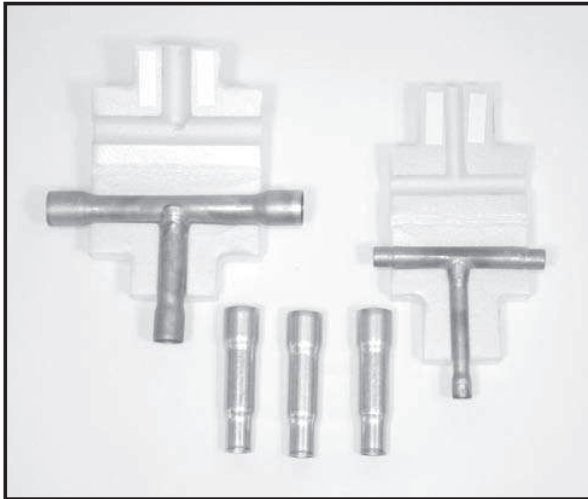

## Descriptions

For double-branching of the refrigerant piping to connect 2 branch boxes. (Brazeing type)

## Applicable Models

- MXZ-8A140VA
- PAC-AK30BC
- PAC-AK50BC

## Dimensions

Unit : mm

### LIQUID PIPE

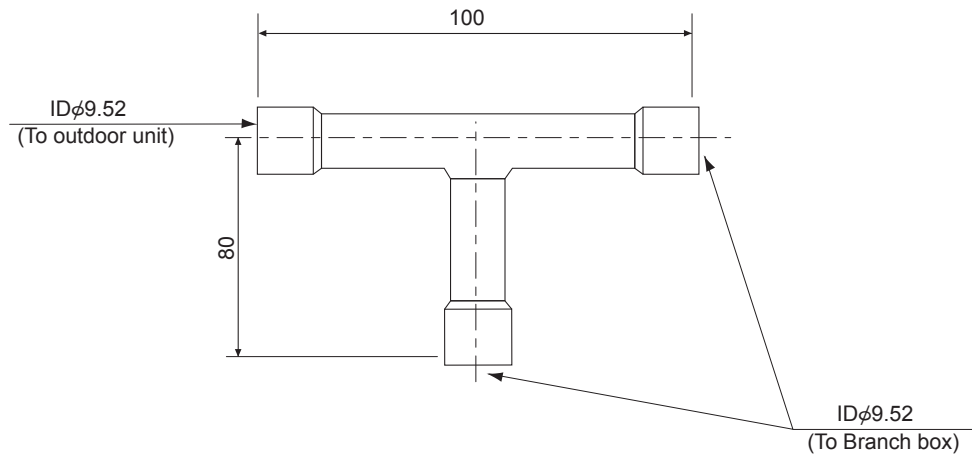

### GAS PIPE

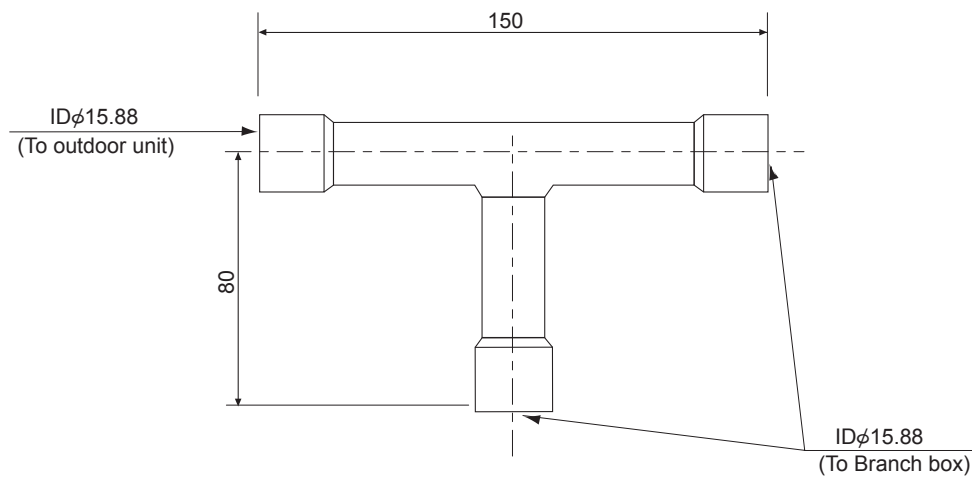

OPTIONAL PARTS

# How to Use / How to Install





## 2-BRANCH PIPE(JOINT) (MSDD-50BR-E)

※In case of 2 branch box connection for welding

Applicable model

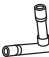
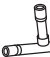
MXZ-8A140VA(R410A type)

### The kit contains followings

① Manual  This one-sheet manual	② Liquid pipe (small: $\phi$ 9.52)  X1	③ Gas pipe (large: $\phi$ 15.88)  X1	④ Heat-insulation cover (small)  X1	⑤ Heat-insulation cover (large)  X1	⑥ Pipe (Gas pipe use: $\phi$ 15.88 → $\phi$ 19.05)  X3
------------------------------------------------------------------------------------------------------------------------	----------------------------------------------------------------------------------------------------------------------------	--------------------------------------------------------------------------------------------------------------------------	-------------------------------------------------------------------------------------------------------------------------	-------------------------------------------------------------------------------------------------------------------------	---------------------------------------------------------------------------------------------------------------------------------------------

Note: Besides these, please procure the following locally:  
(1) Tape for sealing the heat insulation covers.  
(2) Extension pipes for the refrigerant system.

### During installation, be careful about the followings

- Note the limit length of the refrigerant pipe refer to the installation manual of outdoor unit and branch box.
- Note the limits for installing the indoor units refer to the installation manual of outdoor unit and branch box.
- Use solder in connecting any branch joint with any piping system or with the pipe. In soldering, use oxygen-free solder.
- Each branch joint has a stopper.  
In connecting any pipe to any branch joint, thrust the pipe home till it locks.
- In connecting pipes, take care not to let any dirt or other foreign matter enter any pipe.
- Put a heat insulator into every refrigerant pipe.

### Outline of system and pipe size

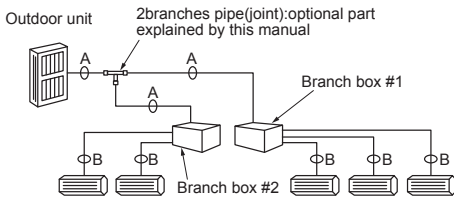

Outdoor unit: R410A type (MXZ-8A140VA)

	A	B
Liquid(mm)	$\phi$ 9.52	Refer to installation manual of outdoor unit and branch box
Gas(mm)	$\phi$ 15.88	Refer to installation manual of outdoor unit and branch box

### See the following for the specifications of liquid pipe, and gas pipe

When outdoor unit is R22 type (MXZ-7A140VC), please connect three pipe⑥ to Gas pipe③ according to [Fig.1]

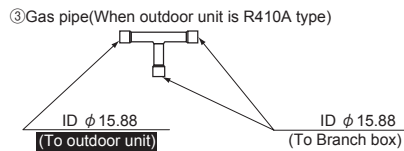
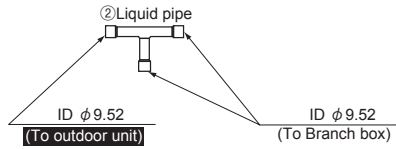

#### ⚠(Prohibition)

Please do not make the following connection.

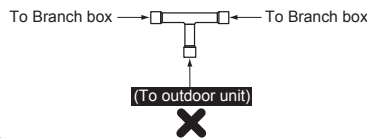

### Installation direction of joint

Horizontal direction



Vertical direction

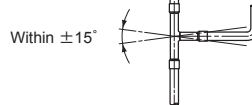

### Installing Heat Insulation Cover and Heat Insulators

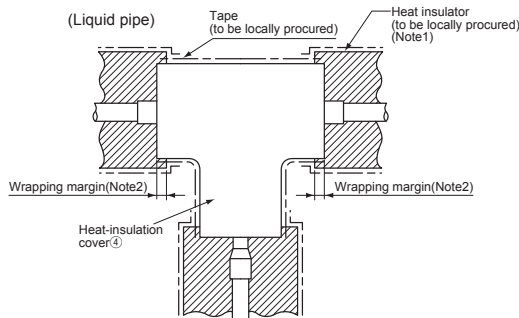

- The liquid pipe (small) Make it fit the heat-insulation cover (small). Seal the mating of the heat-insulation cover with the tape for sealing heat insulators (to be locally procured).

- Do the same with the gas pipe (large), using the heat-insulation cover (large), as with the liquid pipe (small).

Note 1: Install a heat insulator on every part of the refrigerant pipes (to be locally procured).  
If you want to use commercially-available heat insulators, use heat-resistant heat insulators (at least 12mm thick).

Note 2: The pipe covers shrink a little under high heat.  
Therefore, allow for some wrapping margin in the heat insulators.

OPTIONAL PARTS